

## INTERNATIONAL BUSINESS TIMES

### HL23 Green Building Has Slim Design

A new residential building in Manhattan, New York, is going for a small footprint in two ways. First, by seeking LEED gold certification for its energy-efficient and sustainable design features and second, by occupying an area on the ground that's actually smaller than the dimensions of its floors.

This 14 story building, known as HL23, was designed by Los Angeles architect and architectural theorist Neil Denari and features a unique reverse-tapering form that renders its floors 40% wider than the street-level footprint, according to World Interior Design Network. It emerges from a 38.5-foot-wide site near the railbed of Manhattan's re-developed High Lane, near the art galleries of West Chelsea. According to Denari, HL23 "offers proof to the notion that great architecture often arises from the most challenging sites."

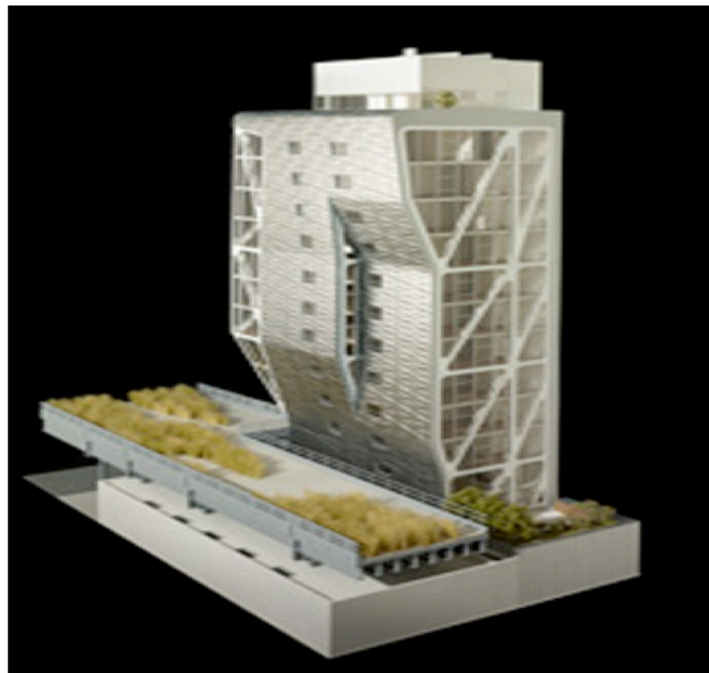

image via Neil Denari

Interiors were designed by Thomas Juul-Hansen, who placed an emphasis on clean, simple designs that vary from floor to floor, in accordance with the unusual shape of the building. On some levels, floor-to-ceiling low-iron glass windows compose two of the three exterior walls, while on other floors, an open central loft-like living space is paired with more traditional domestic spaces that provide privacy.

Green features include recycled and low-VOC paints, finishes and adhesives; high-efficient boilers and LEED-certified perimeter heat systems; and a cooling tower with sound attenuation. The electric elevator additionally reduces energy consumption by functioning without the support of a machine room.

While it's still waiting on its LEED certification, the building has already won several awards, including The SARA NY 2010 Visionary Architecture Award and the Honor Award from the Los Angeles Chapter AIA Next LA Awards Program. It is scheduled for official unveiling on June 1 of this year.